APP'S USER MANUAL (LIGHT)

Use your phone to scan the QR code below or search “Smart Life” in application market to download and install the App



Register

If you don't have an App account, register an account or sign in with verification code by SMS.

This page describes the registration process.

1. Tap to enter registration page
2. The system automatically recognises your country / area. You can also select your country code. Enter the mobile number/E-mail and tap "Next", as shown in the picture 2
3. If you enter the mobile number, then enter the verification code in the message, as shown in the picture 2, and enter the password, tap "Confirm" to finish your registration.
4. If you enter the E-mail, enter the password as shown in the picture 4, and, tap "Confirm" to finish your registration.

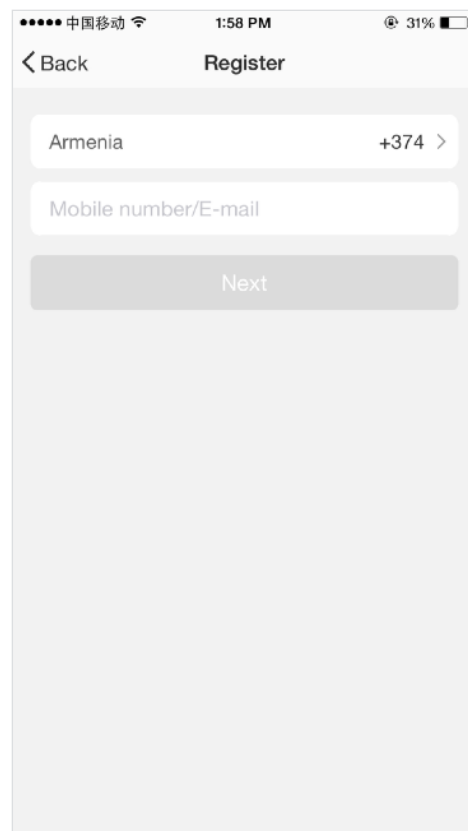

Picture 1

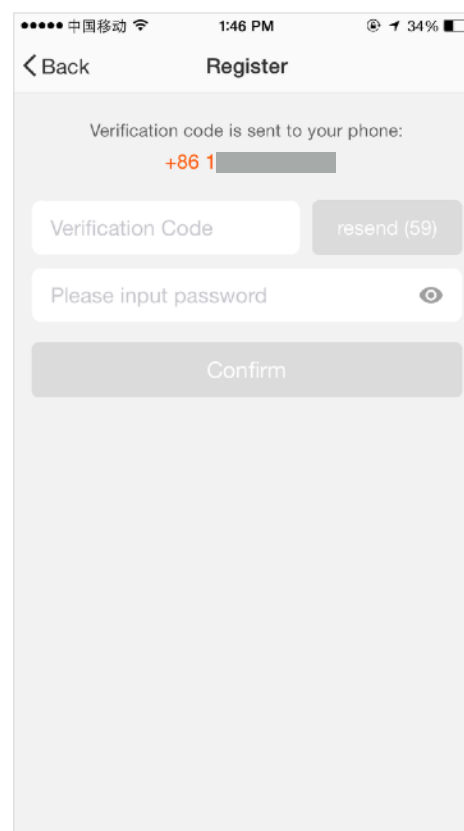

Picture 2

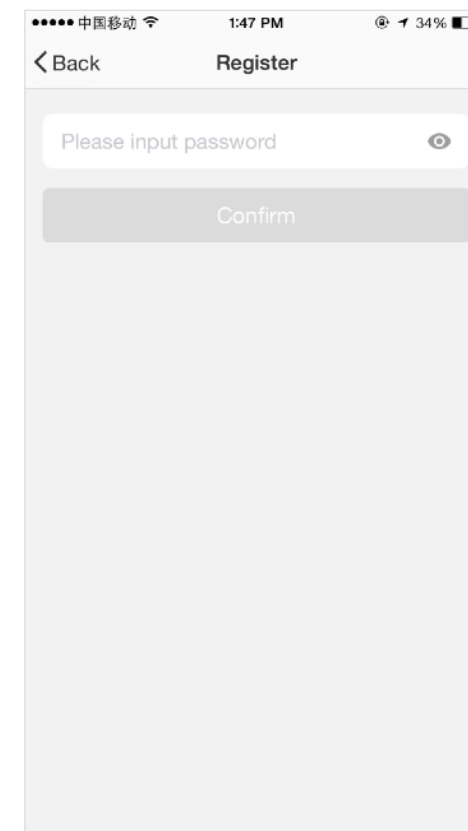

Picture 3

中国移动 1:53 PM 32%

Login

Country / Region Armenia +374 >

Mobile number/E-mail

Password

Login

Sign in with SMS verification Forgot password

Sign in with social media account

facebook twitter

Sign in with username and password

- 1.The system automatically recognises your country / area. You can also select your country code.Enter the mobile number/E-mail and tap “Next
- 2.Enter your registered mobile number or Email, and password to login.

Sign in with social media account

If you have installed Facebook or Twitter in your smartphone, tap the corresponding icons and then sign in the App after social network authentication

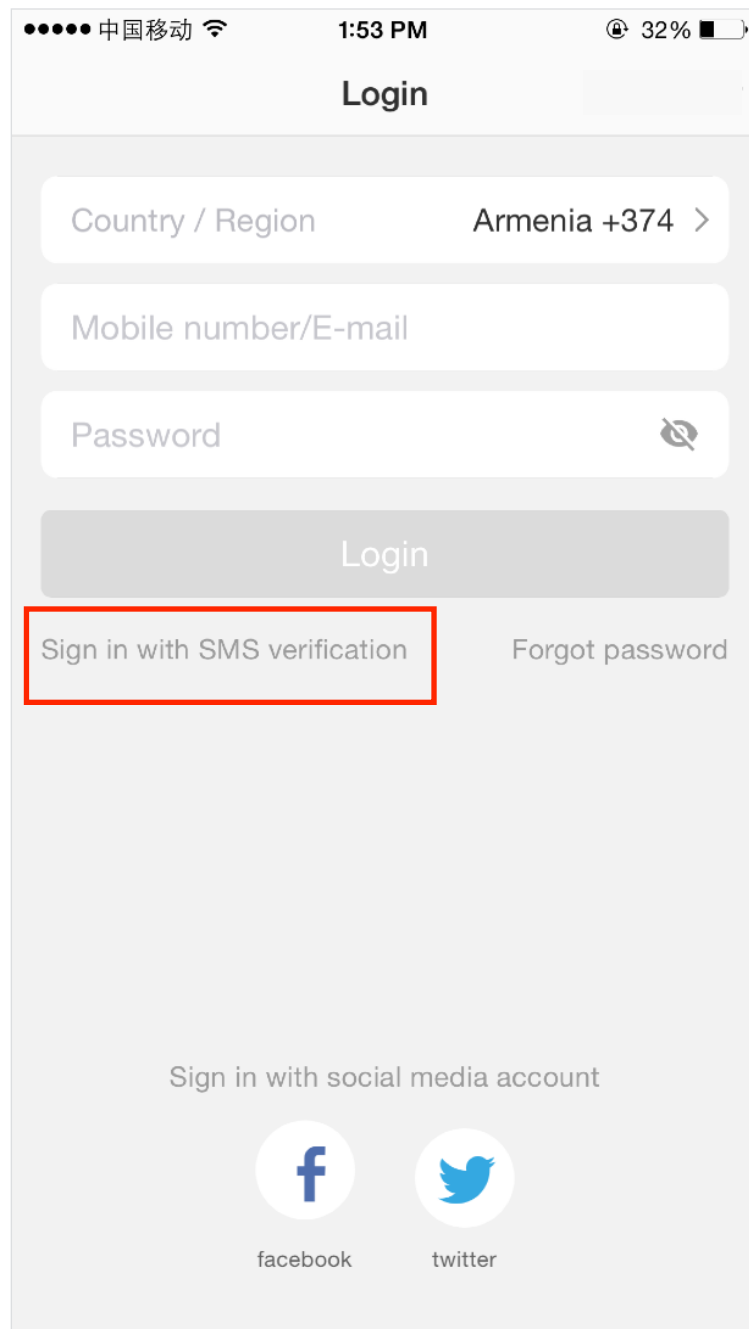

Screenshot of the Login screen. The status bar at the top shows the carrier as 中国移动, the time as 1:53 PM, and the battery level at 32%. The screen title is "Login". Below the title, there are three input fields: "Country / Region" (pre-filled with "Armenia +374"), "Mobile number/E-mail", and "Password" (with a toggle for visibility). A "Login" button is positioned below these fields. At the bottom of the login section, there is a link "Sign in with SMS verification" which is highlighted with a red rectangle, and a link "Forgot password". At the very bottom, there is a section titled "Sign in with social media account" featuring icons for Facebook and Twitter.

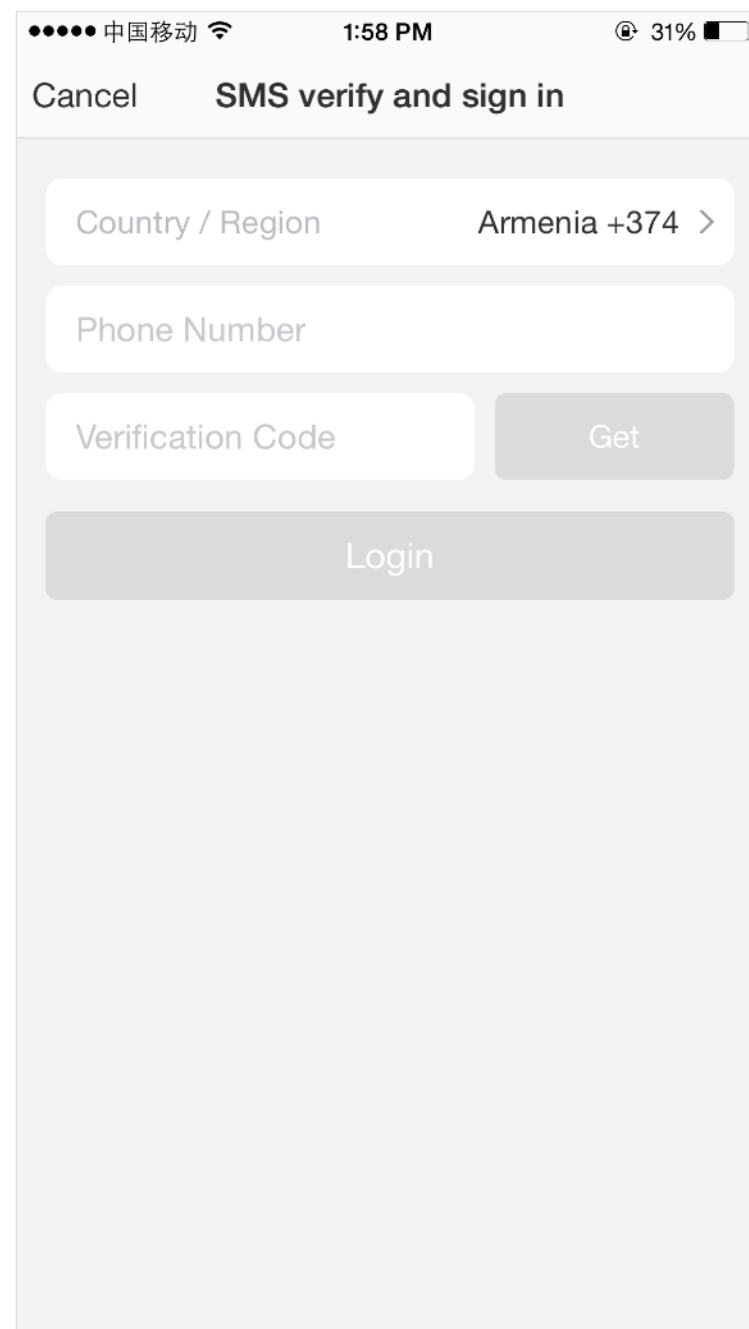

Screenshot of the SMS verification screen. The status bar at the top shows the carrier as 中国移动, the time as 1:58 PM, and the battery level at 31%. The screen title is "SMS verify and sign in". Below the title, there are three input fields: "Country / Region" (pre-filled with "Armenia +374"), "Phone Number", and "Verification Code". A "Get" button is located to the right of the "Verification Code" field. A "Login" button is positioned below the input fields. A "Cancel" button is located at the top left of the screen.

Sign in with verification code via SMS

1. Tap "Sign in with SMS verification", to new page
2. The system automatically recognises your country / area. You can also select your country code by yourself.
3. Enter the mobile number and tap "Get" to get a message
4. Enter the verification code in the message and tap "Login" to login the App

Forgot password

To find your password back, please follow the procedures:

1. Tap "Forgot password", as shown in the picture 1
2. The system automatically recognises your country / area. You can also select your country code by yourself. Enter the mobile number/E-mail and tap "Next", as shown in the picture 2
3. Enter the verification code in the message/E-mail, as shown in the picture 3, and enter the new password, tap "Confirm" to finish.

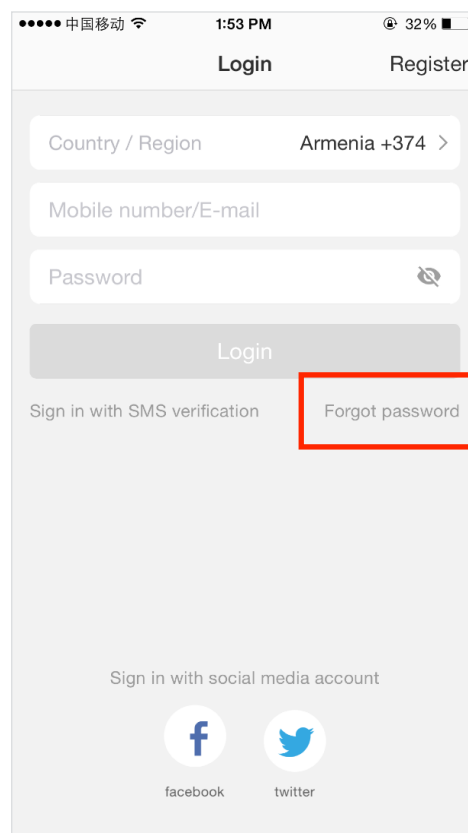

Picture 1

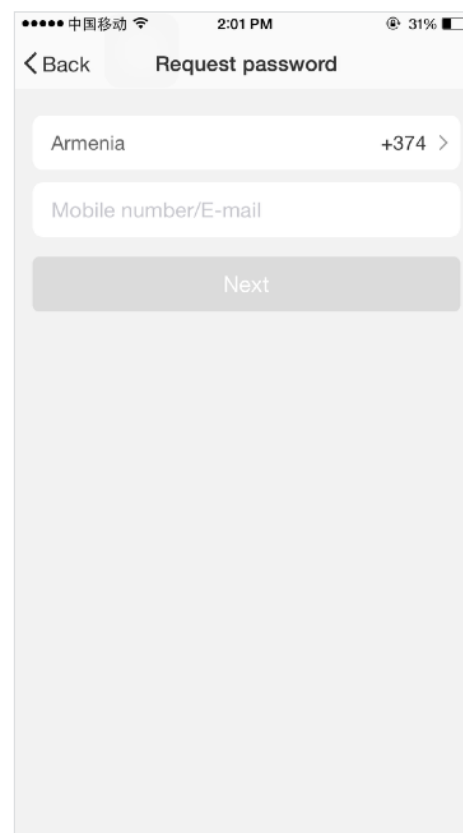

Picture 2

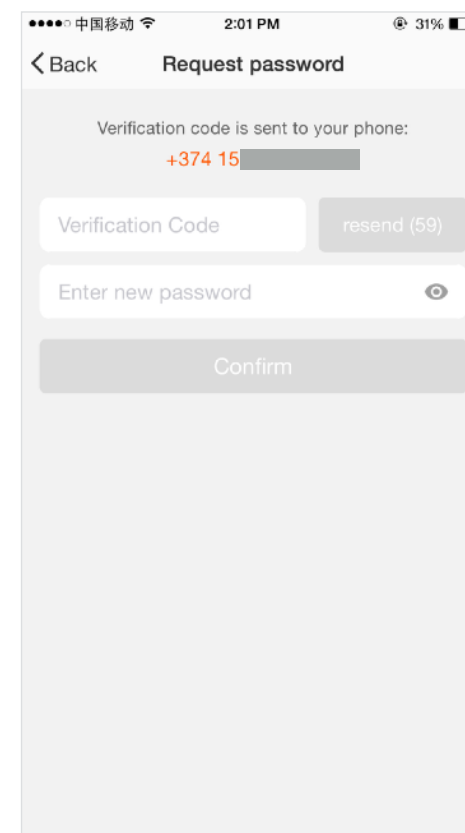

Picture 3

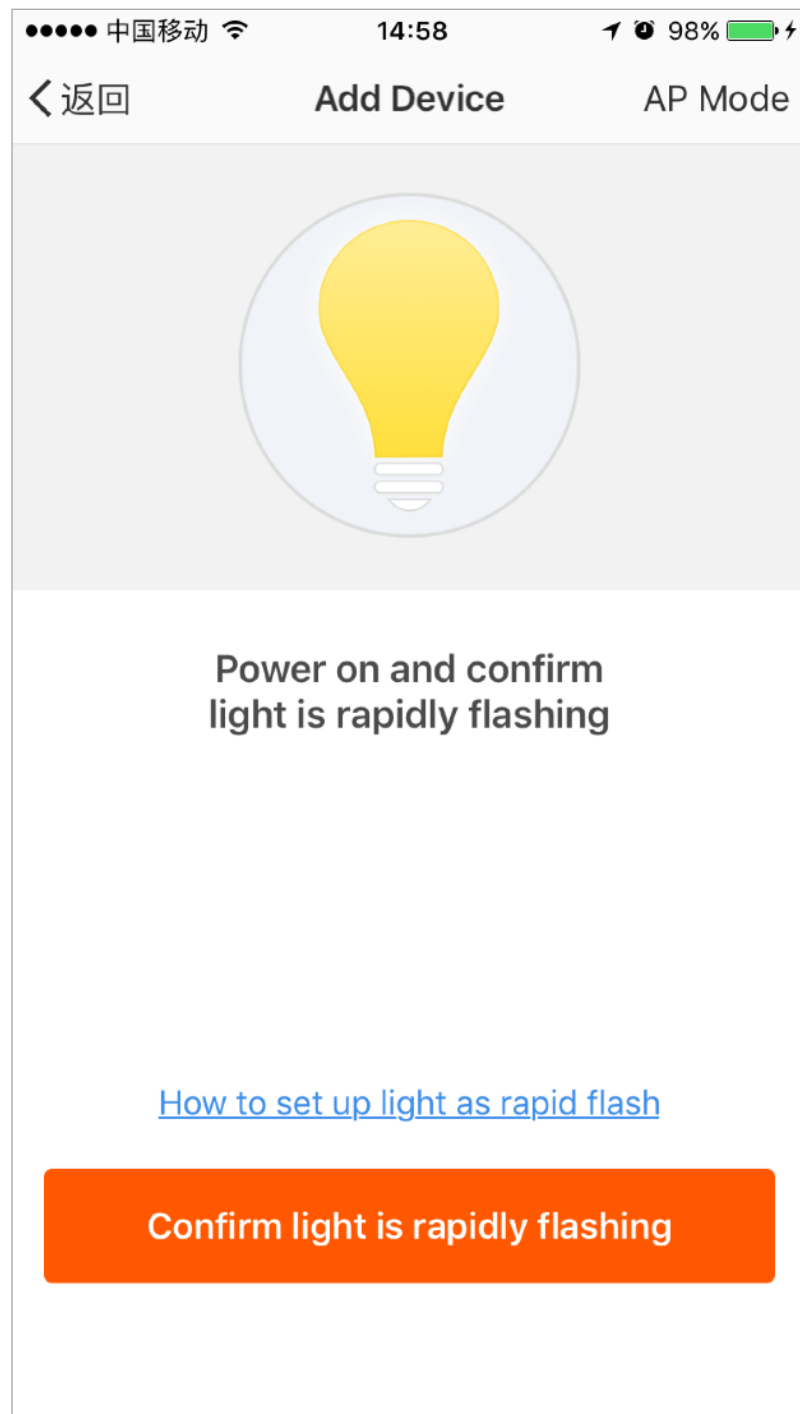

1. Enter the App, tap "+" in the upper right of the page to enter network connection page, as shown in the picture
2. There are two network connection methods (Normal mode and AP mode). Normal mode is default. Users could tap the upper right corner to switch the connection method to AP mode.
3. For normal mode, please make sure the light rapidly flashes (2 times per second), tap to go on to the next step
4. If light is not rapidly flashing, tap "how to set light as rapid flashes" to view operation processes.

NO.2 Add device-Normal mode

Notes: How to set light as rapid flashing

Step 1

Power on device.
Power off after 10s and then power on

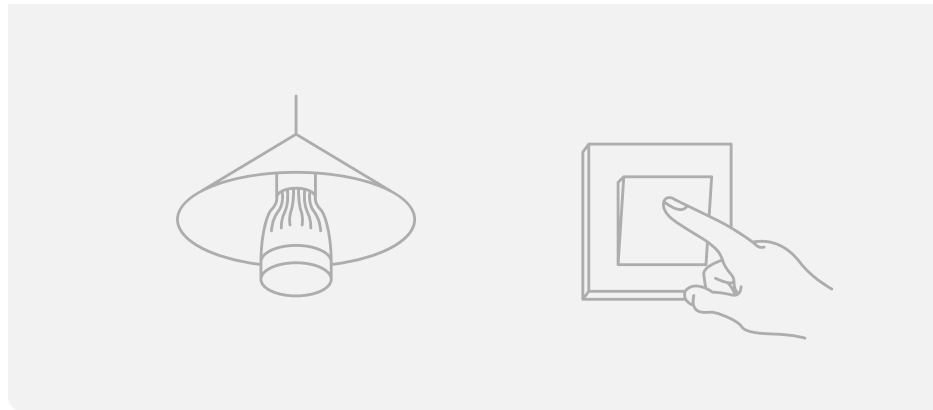

Step 2

Turn on-off-on-off-on
(Keep time interval not too short, turn off after light is on)

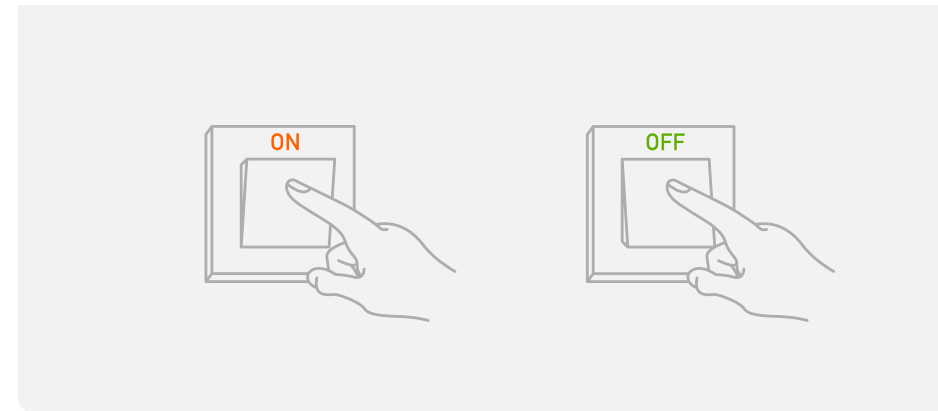

Step 3

Confirm light bulb is now rapidly flashing



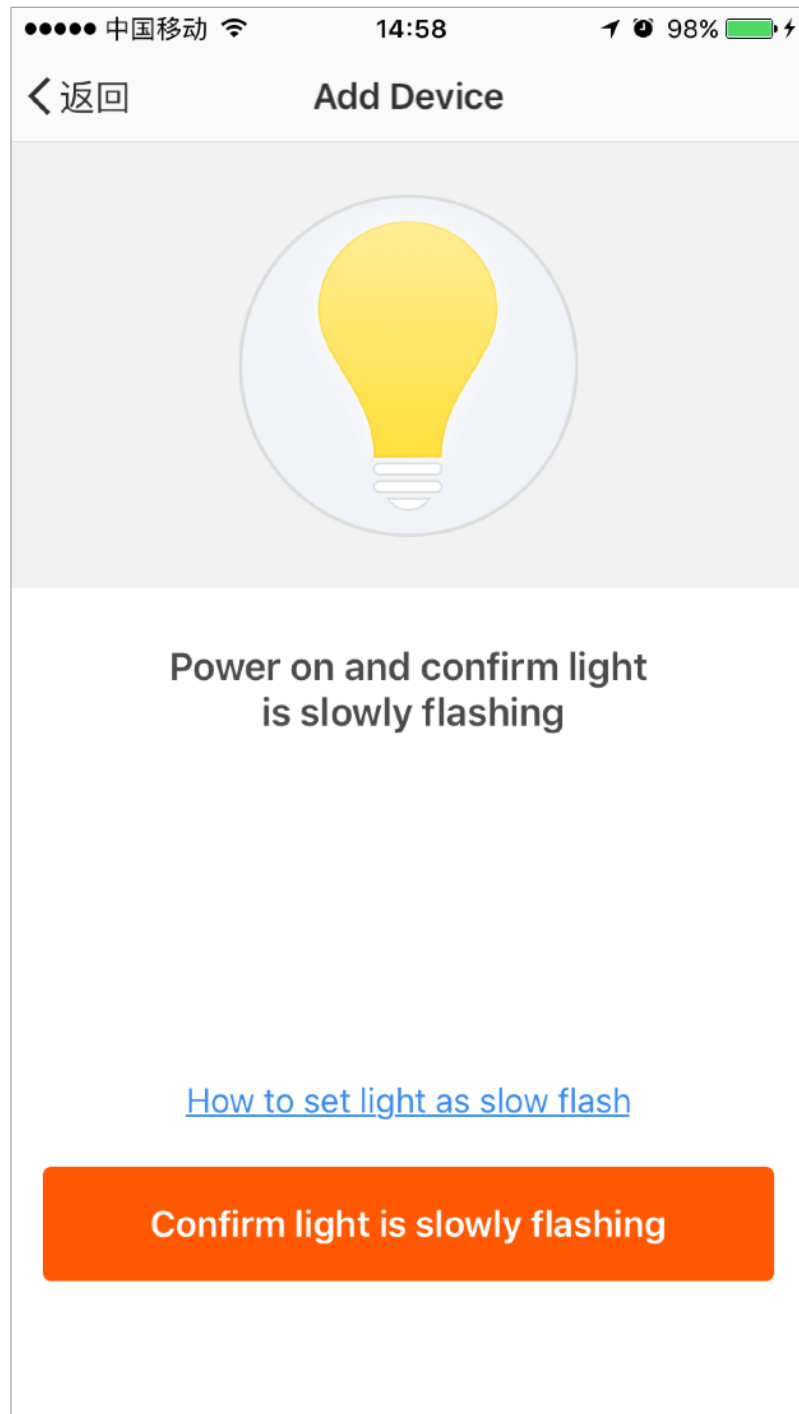

1. For AP mode, please make sure the device's indicator light slowly flashes (1 time every 3 seconds), tap to go on to the next step
2. If light is slowly flashing, tap "how to set light as slow flashes" to view operation processes.

Notes: How to set light as slow flashing

Step 1

Power on device.
Power off after 10s and then power on

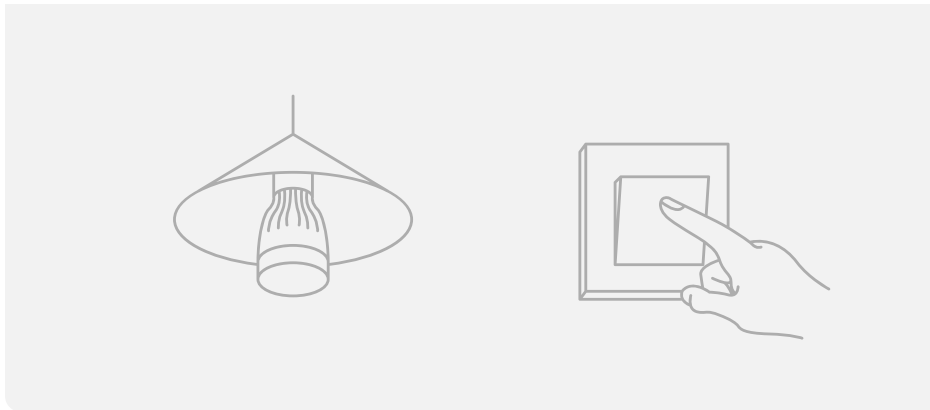

Step 2

Turn on-off-on-off-on
(Keep time interval not too short, turn off after light is on)

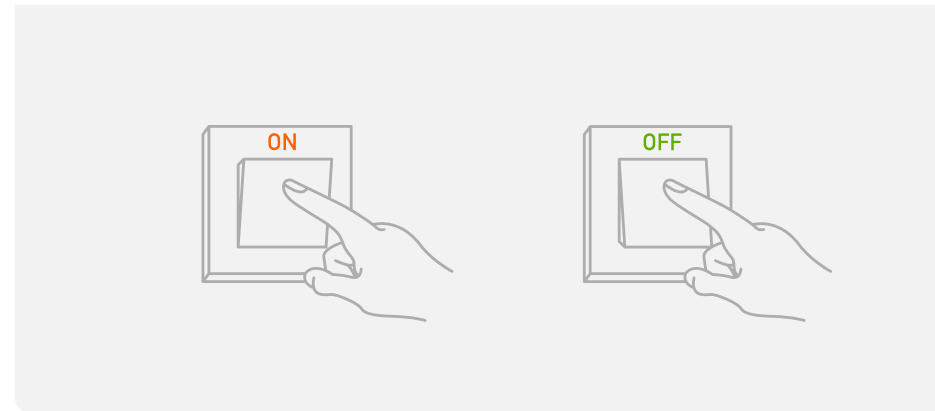

Step 3

Confirm light bulb is now rapidly flashing



Step 4

Operate again: Turn on-off-on-off-on
until light is slowly flashing



NO.2

Add device-Enter Wi-Fi password

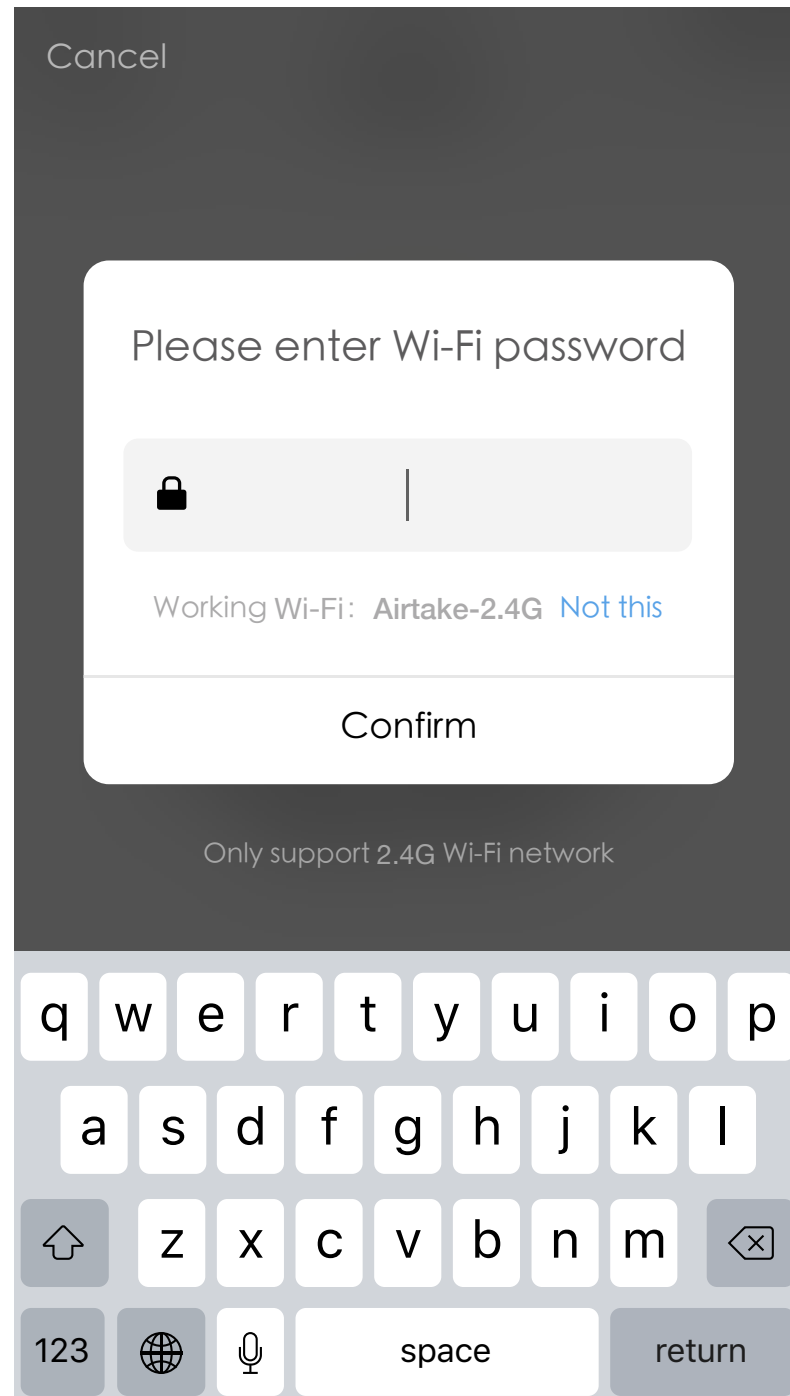

Select the Wi-Fi under which device is working, enter password and tap “Confirm” to enter network connection process, as shown in the picture below

If you select normal mode to connect device to the network, the App goes through the processes as shown in the picture 1. After the network connection is successfully, the App page will be shown in the picture 2



图1



图2

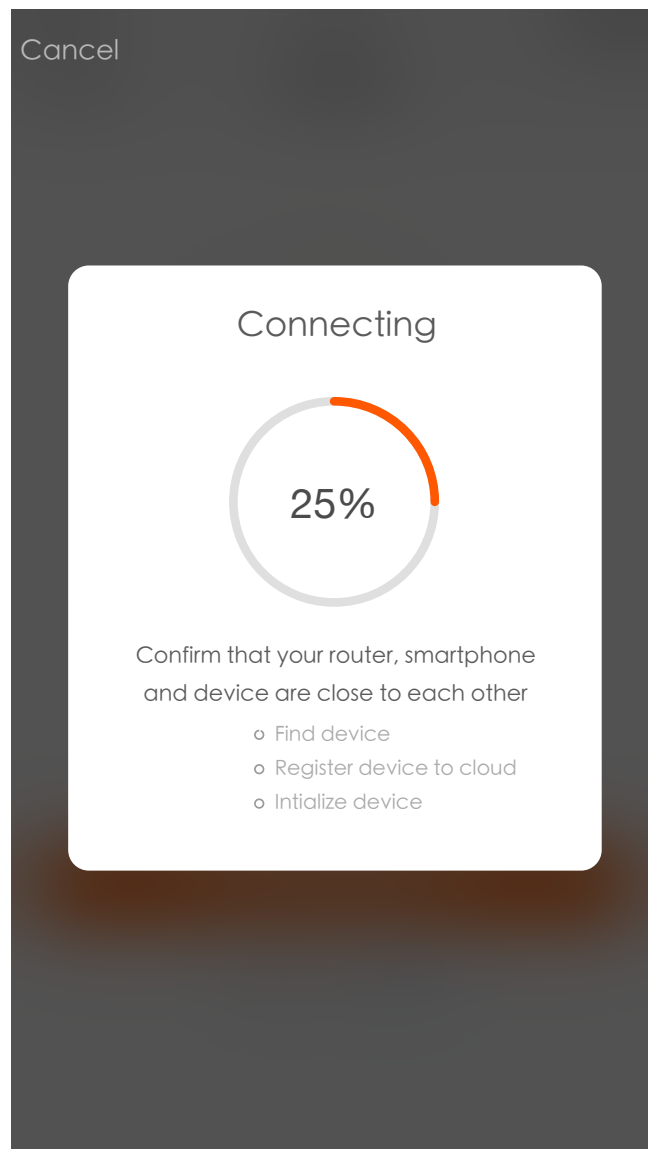

For AP mode, connect to the Wi-Fi hotspot named "SmartLife", as shown in the picture

Notes: Some devices might have different hotspot names.

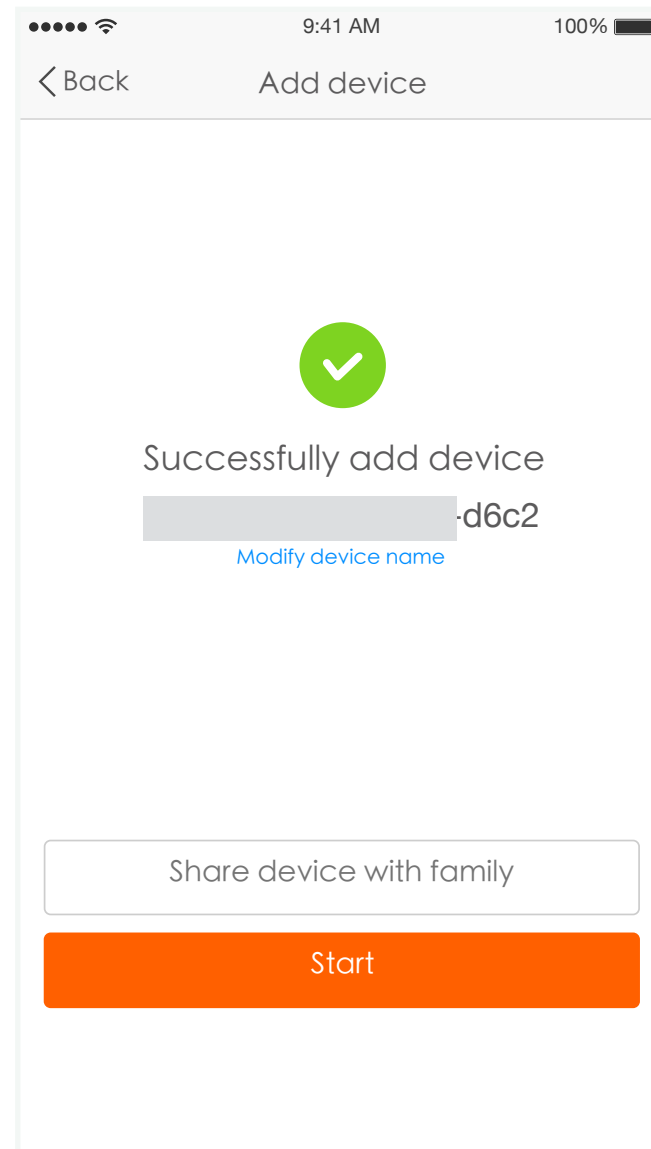
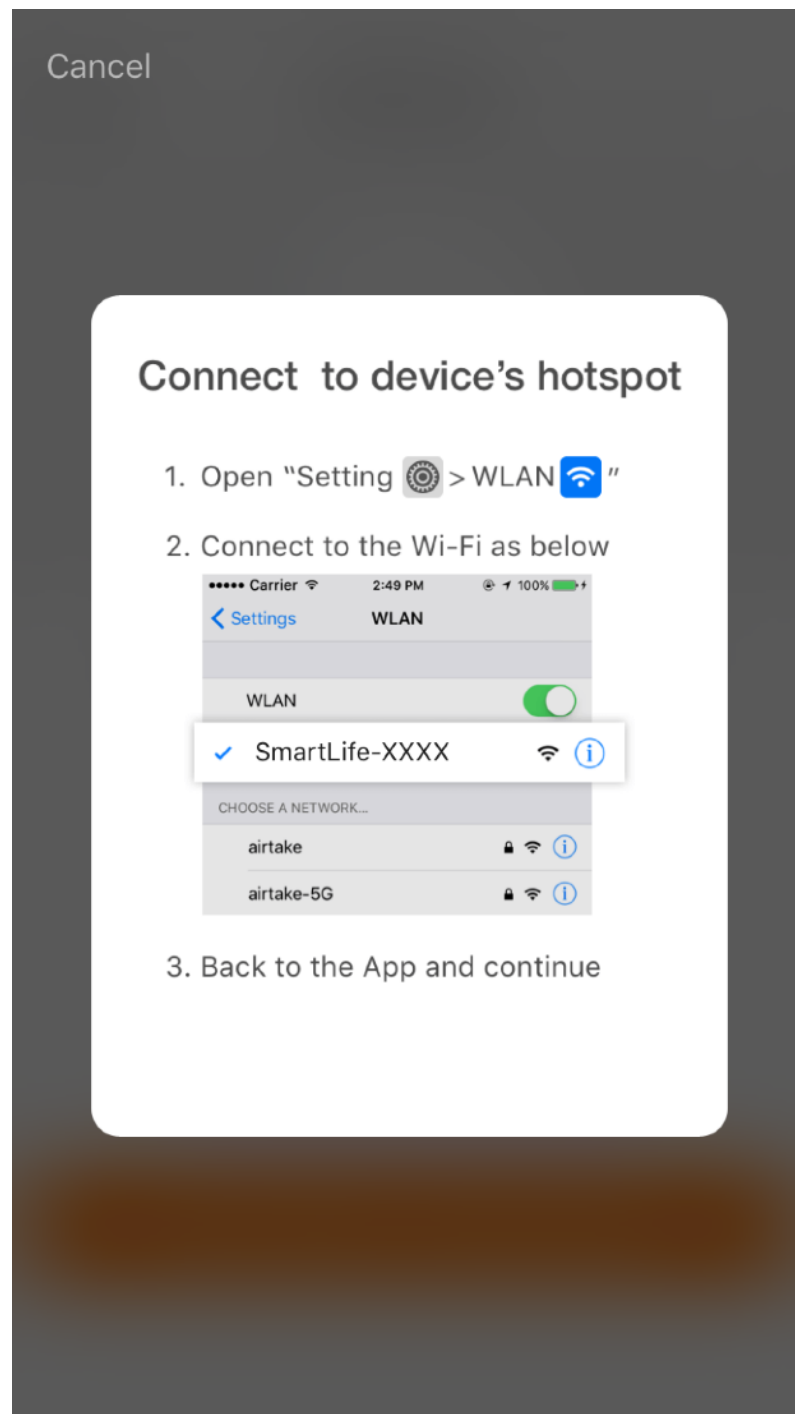
After connecting with the hotspot, back to the network connection page to enter network connection process. The App goes through as shown in the picture 1. Picture 2 shows the App page when the network connection is successful.

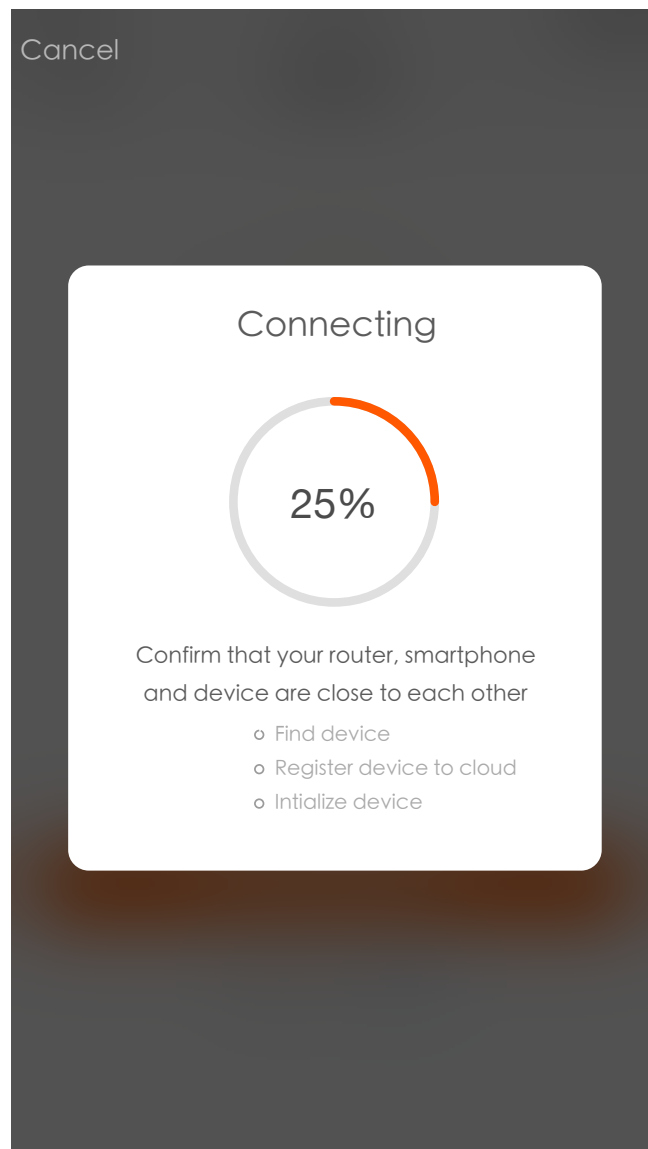

Picture 1

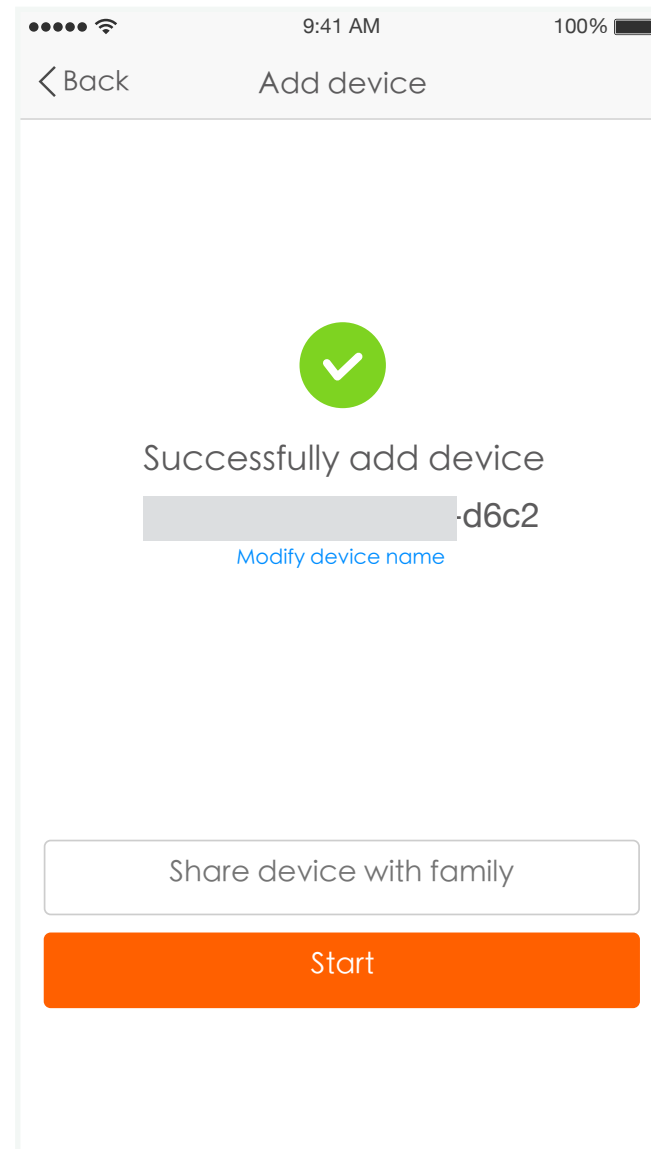

Picture 2

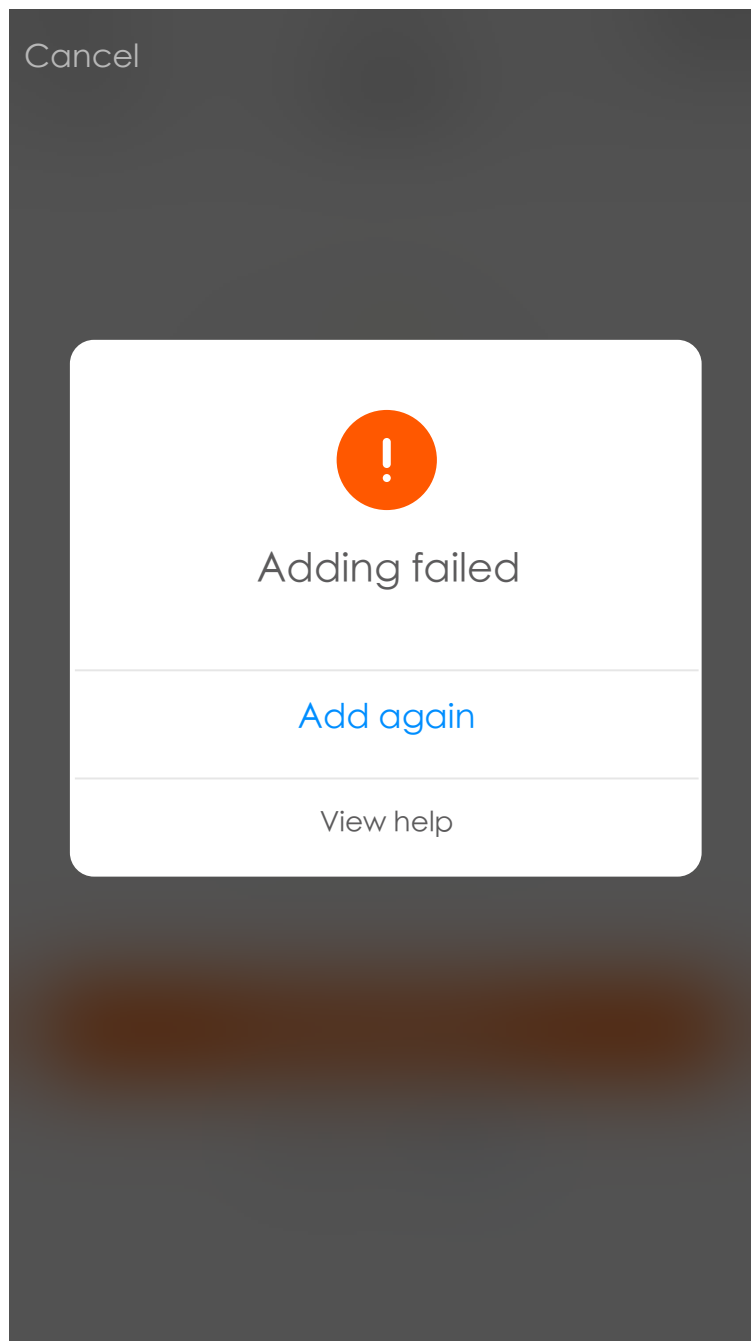

If your App interface is shown as in the picture, it means that the network connection failed. You could try by connecting again or view help.

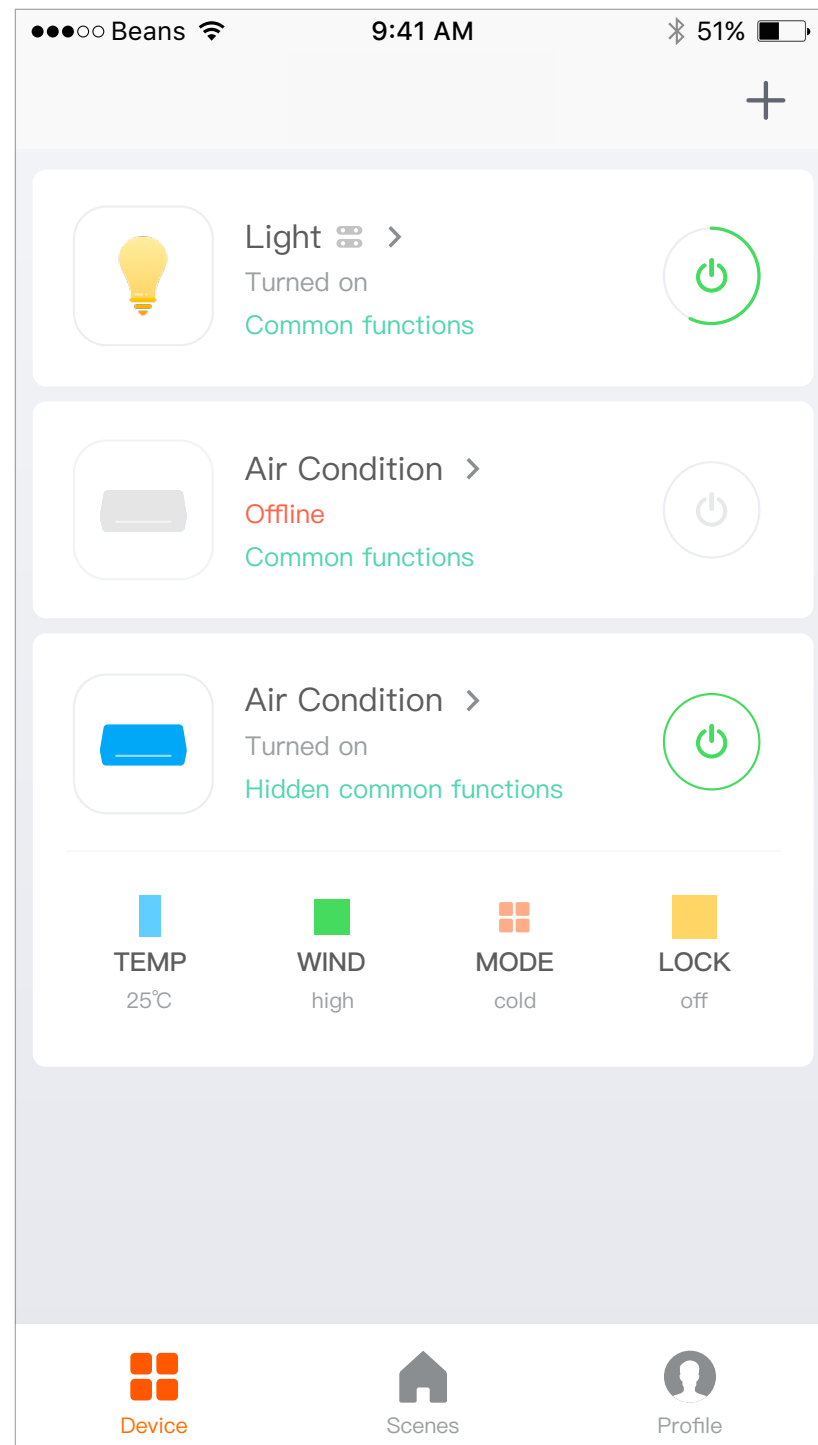

After successfully configuring the devices, the smart device will be shown on the home page. Tap to enter its control page

Note:

1. When device is online, it support short-cut operations
2. When device is offline, it displays “Offline” and can be controlled.

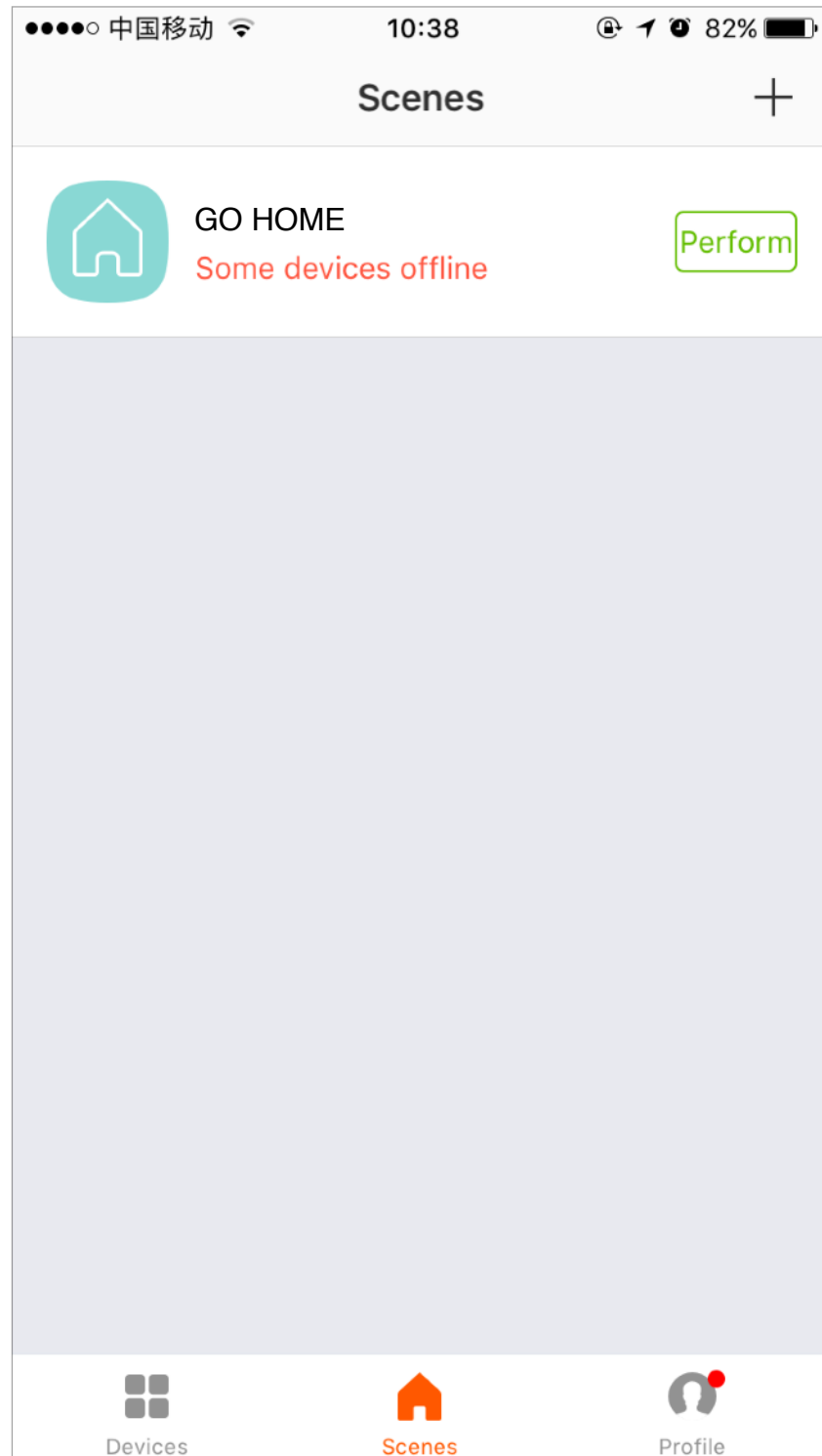

Smart life scenario supports that devices perform corresponding actions under various conditions. The main conditions include:

- 1.Temperature
- 2.Humidity
- 3.Weather
- 4.PM2.5
- 5.Air quality
- 6.Sunrise & sunset time
- 7.Device's actions (such as turn on/ff)

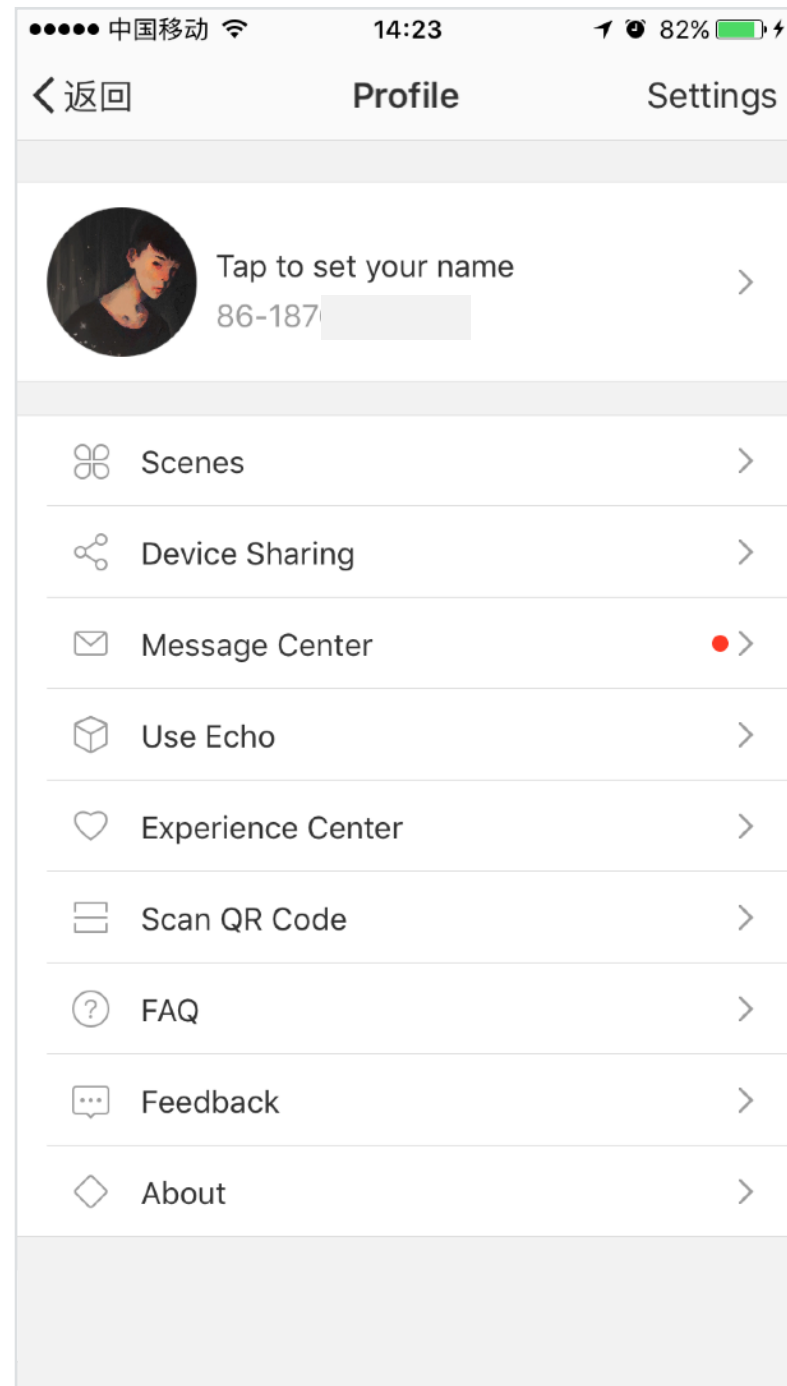

“Profile” page is where users could manage personal information. The key information is as follows:

1. Personal information
2. Smart life scenario
3. Device Sharing: display the information of shared devices
4. Message center
5. F.A.Q
6. Entry to submit feedback
7. About

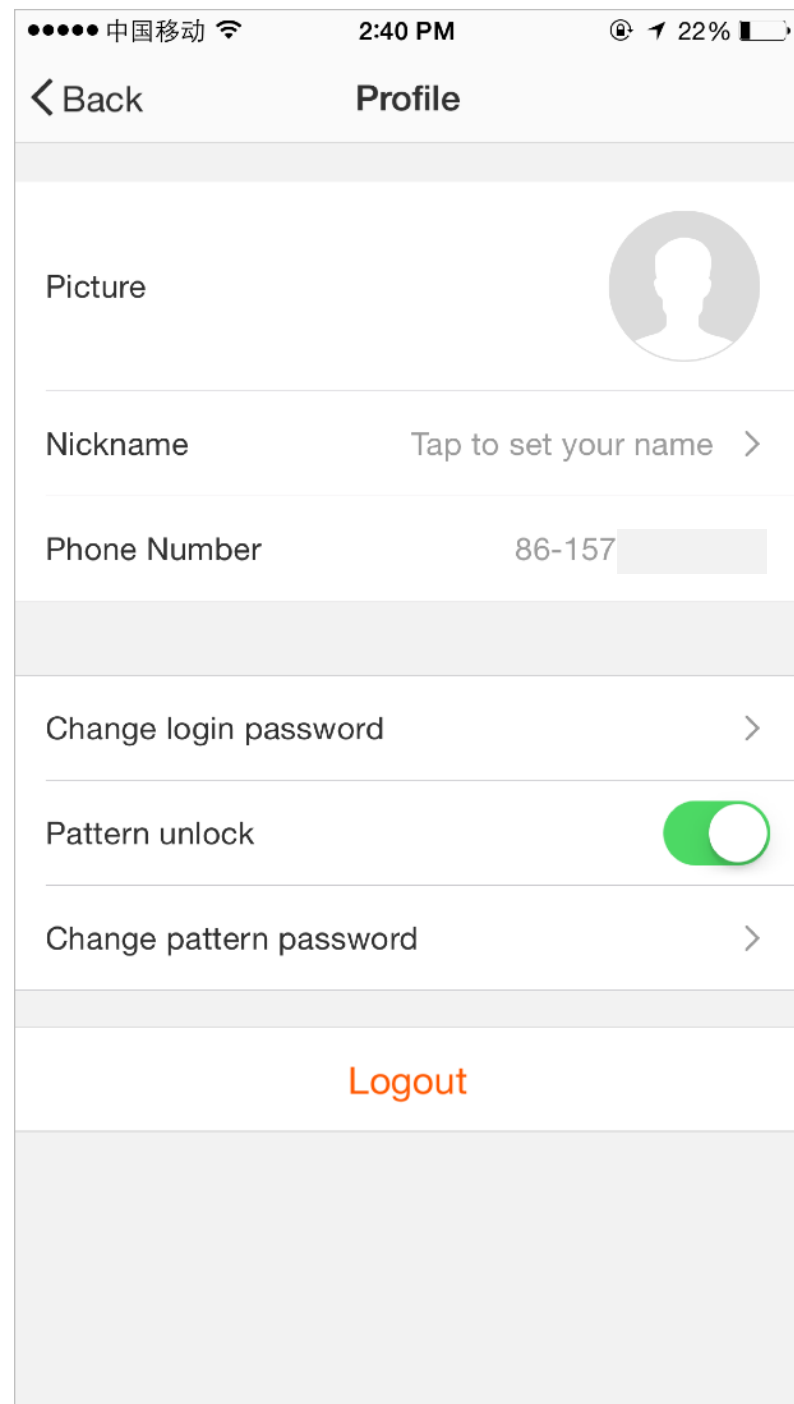

“Profile” page is for displaying personal account information. You can change login password, binding mobile number, set pattern unlock on this page.

NO.4 Profile

Tap “Pattern unlock” to set your pattern. After setup, you have to enter your pattern to use the App

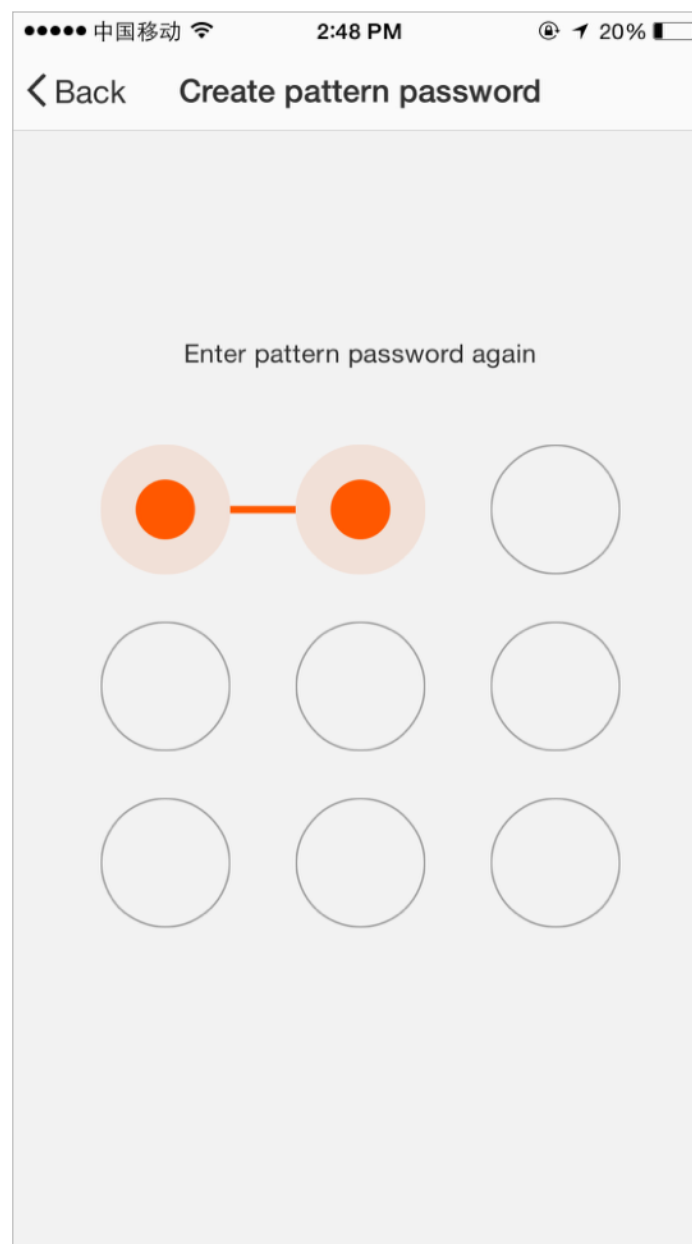
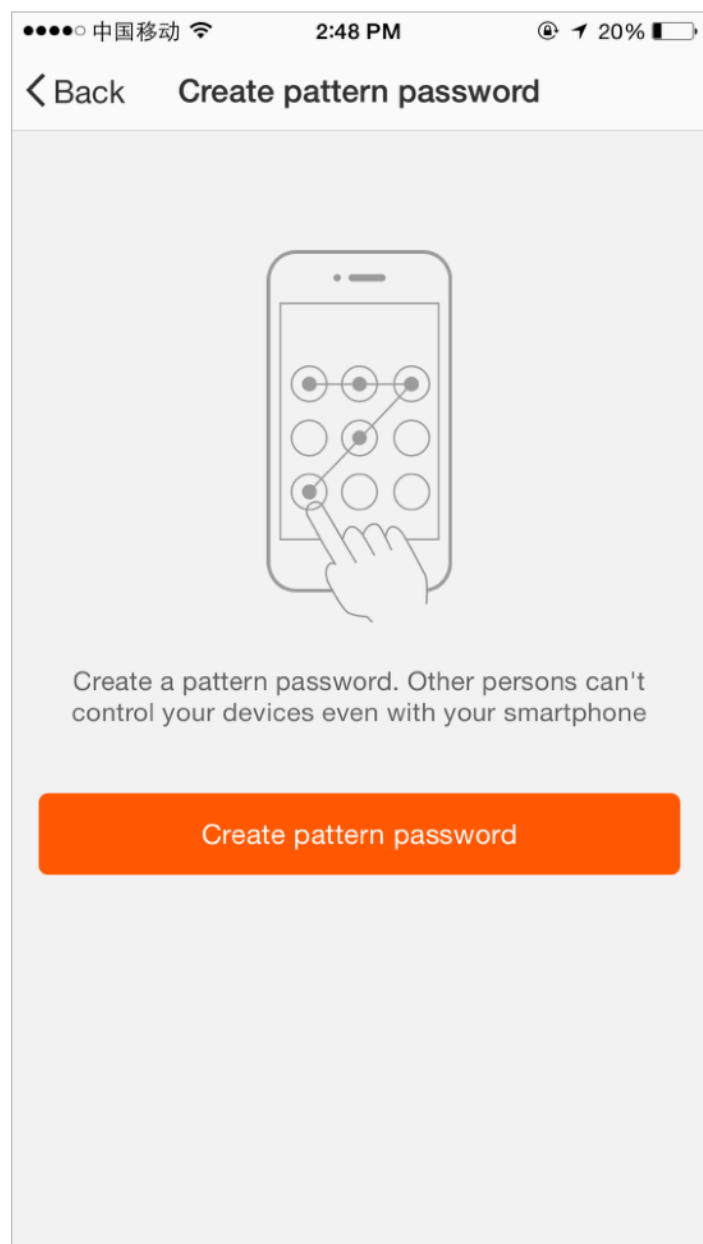

NO.4 Profile-Pattern Unlock

Send sharing: The list shows all members who are added by your account. You can delete the member and delete the sharing by swiping left.

Receive sharing: The list shows all devices that your account has received. You can delete the sharing by swiping left.

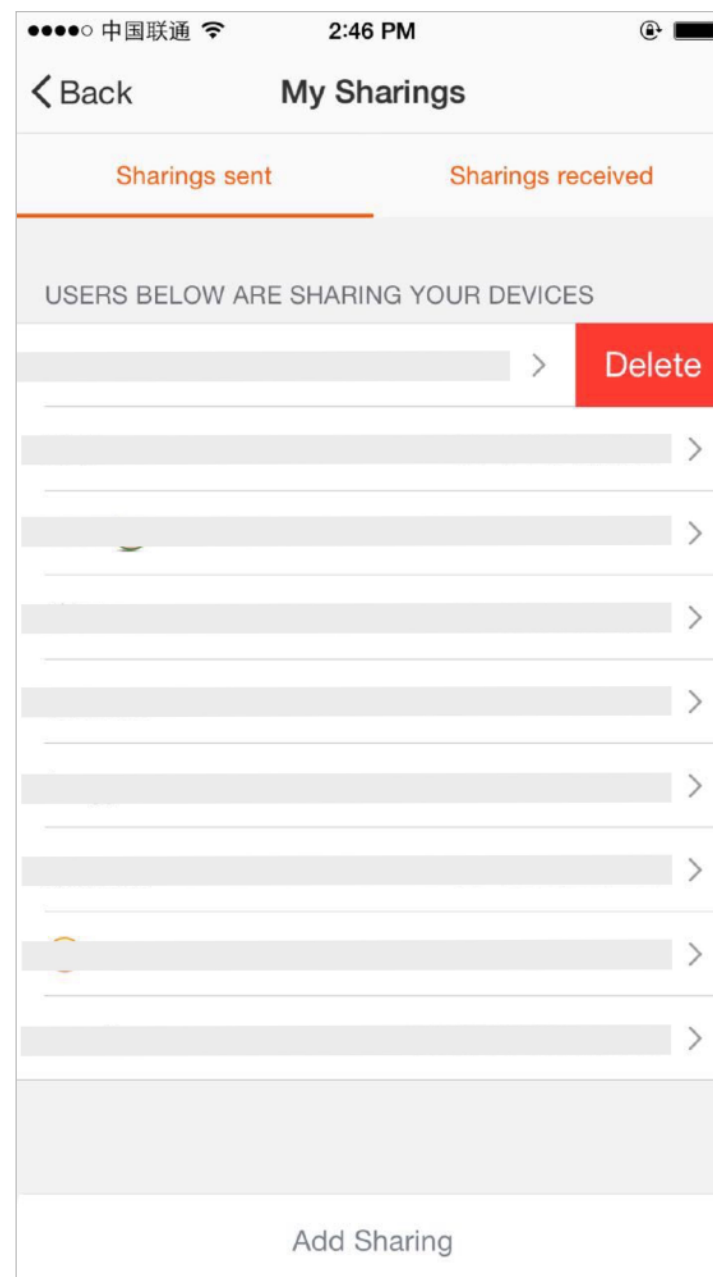
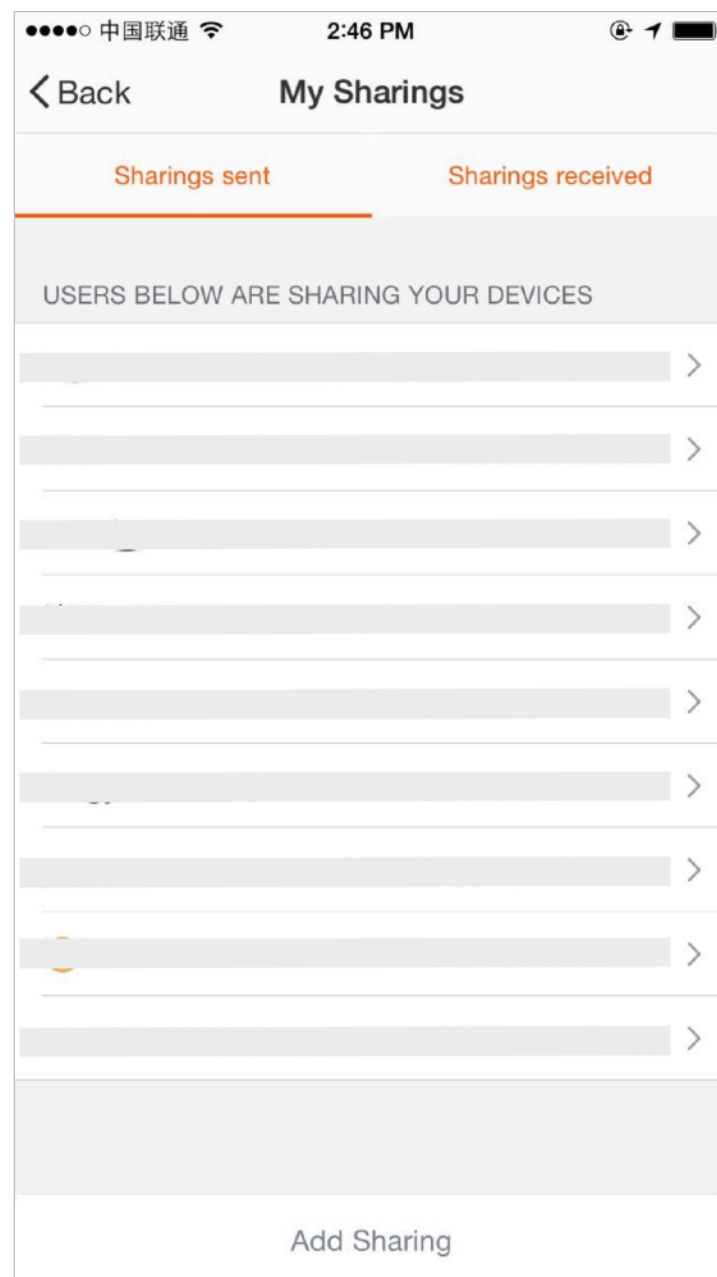

NO.4 Profile-Device Sharing

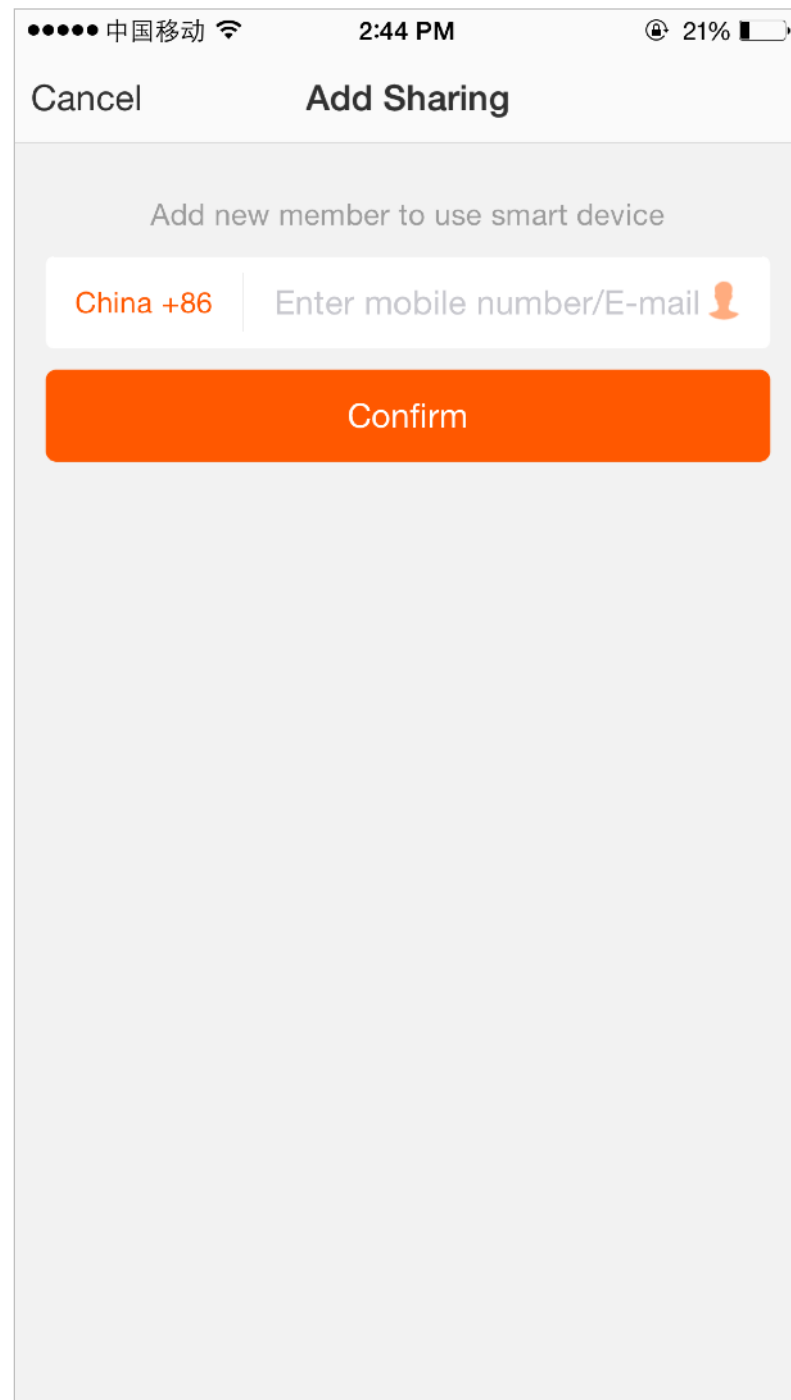

The screenshot shows an iOS-style dialog box titled "Add Sharing". At the top, there are status bar elements: signal strength, "中国移动", time "2:44 PM", and battery level "21%". The dialog has two buttons at the top: "Cancel" on the left and "Add Sharing" on the right. Below the title bar, the text "Add new member to use smart device" is displayed. Underneath is a form with a dropdown menu showing "China +86" and a text input field with the placeholder "Enter mobile number/E-mail" and a person icon. At the bottom of the form is a large orange button labeled "Confirm".

Add sharing: As shown in the picture, users could input a new member's mobile number and share the device with him. The new member could then control the shared device.

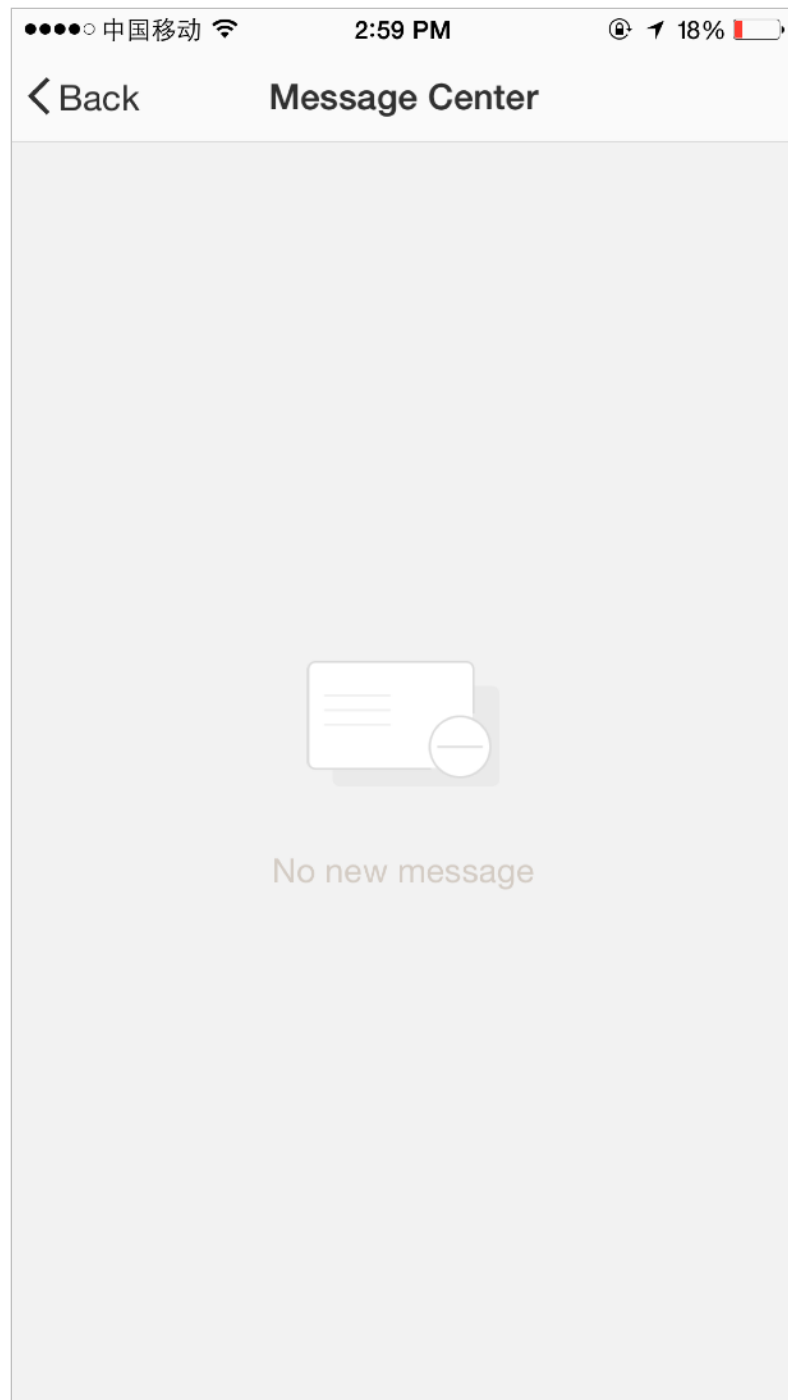

Message centre: Including notifications of new device and new sharing

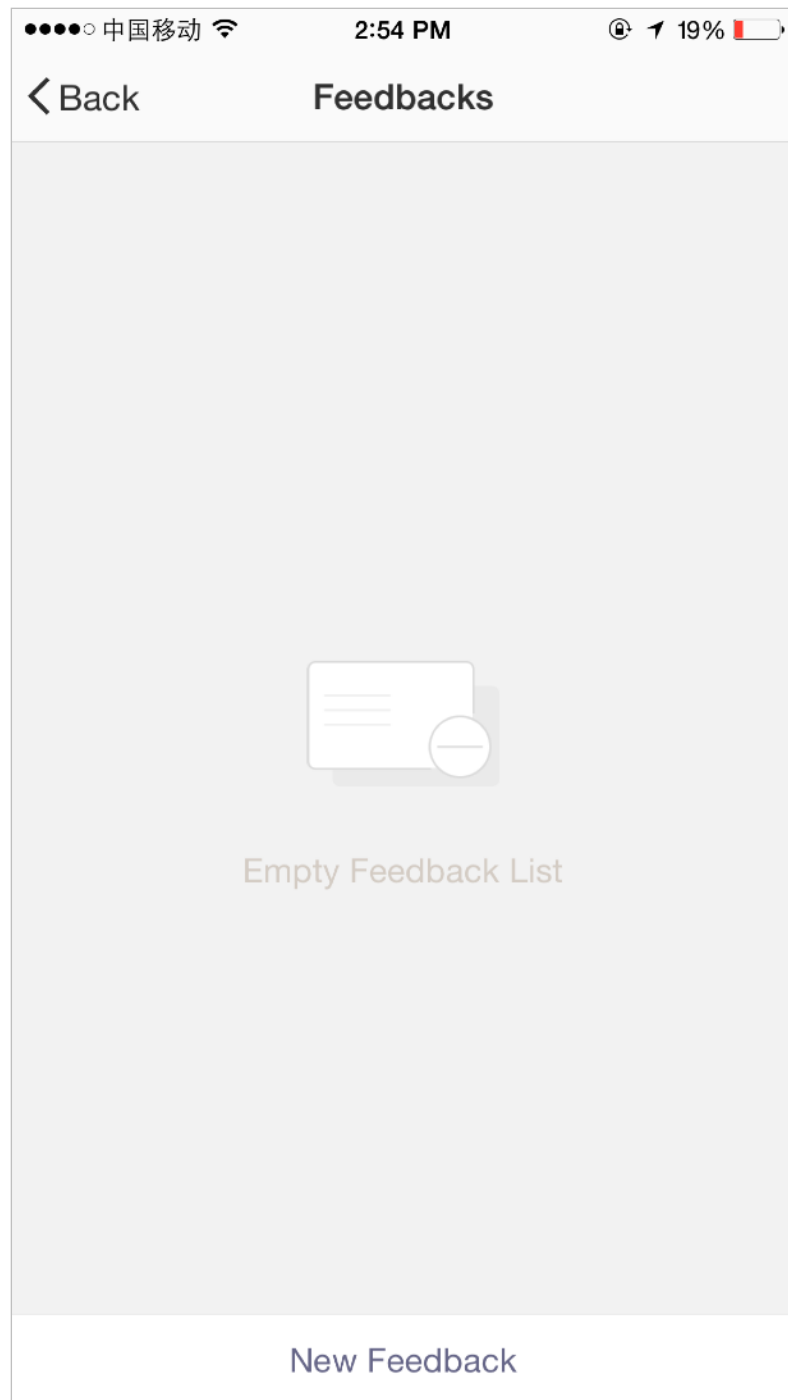

Feedback: Entry where users could submit their feedback

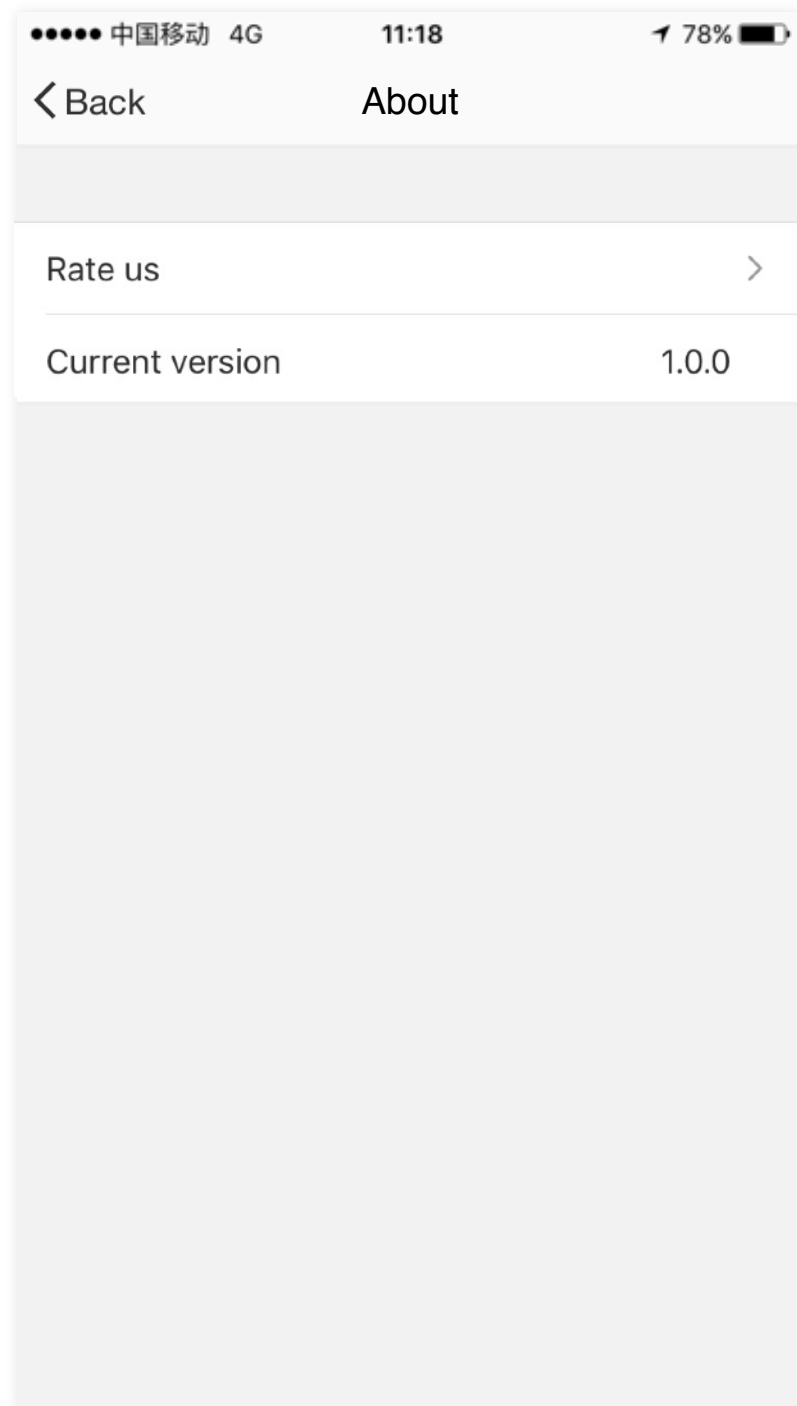

App's other related information include:

1. Tap on "rate us", App will be redirected to a corresponding App market, where you could rate us
2. Show App version number

Thank You

Remark:

- 1) The pictures used in this manual are iOS app interface, Android version is a bit different.
- 2) Product and software update periodically, the number and app interface in this manual are only for example. No extra notification on further changes.